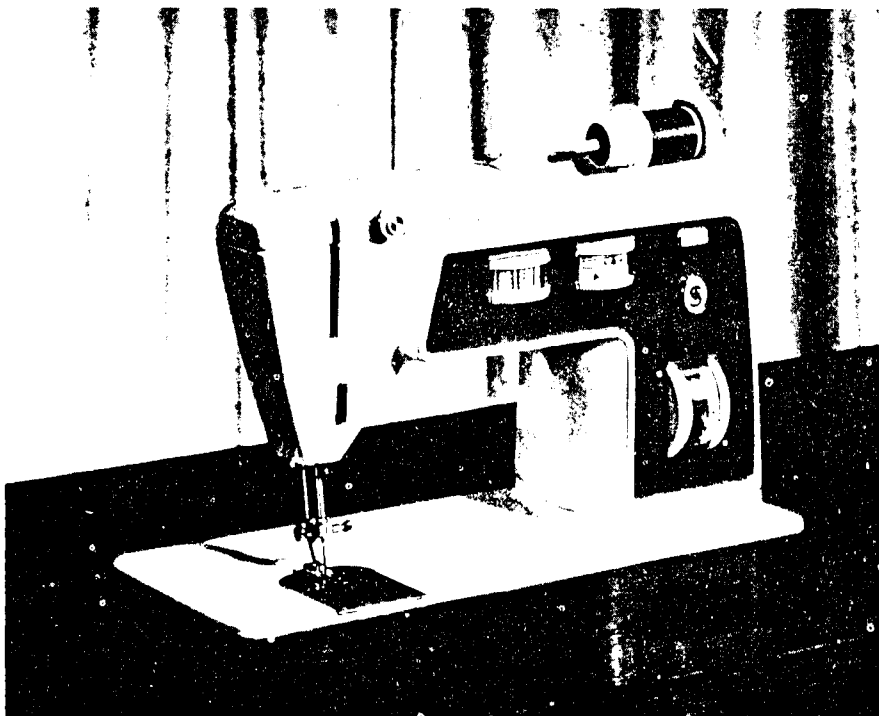

SINGER
756E3/756E6/756E7

List of Parts—Machines Nos. 756E3, 756E6 and 756E7

ATTACHMENT SET 171242

21906	Chainstitch Attachment Loop Retainer Disc
102884	Container (plastic) with Twin Needle Catalog 2028, Size 14 and two Needles Catalog 2045, Size 14
161133	Tube of Oil
161166	Presser Foot complete, for cording and slide fastener work
161168	Presser Foot, for button sewing
161172	Seam and Blindstitch Hem Guide complete
161276	Lint Brush
161917	Presser Foot Plate (snap-on), for sewing buttonholes
161919	Presser Foot Plate (snap-on), for straight sewing
161960	Glassine Envelope containing two needle threader hooks and an Instruction Sheet (Form 21632)
163131	Bobbin (3)
163455	Chainstitch Attachment Thread Guide
163483	Special Purpose Presser Foot
171137	Throat Plate, for straight sewing
171138	Feed Cover Plate, for darning and embroidery
171150-656	Spool Pin, for two needle sewing
171234-656	Attachment Box complete
171238	Chainstitch Attachment Throat Plate
-----	Needle Catalog 2020, Size 14 (3)

List of Parts—Machines Nos. 756E3, 756E6 and 756E7

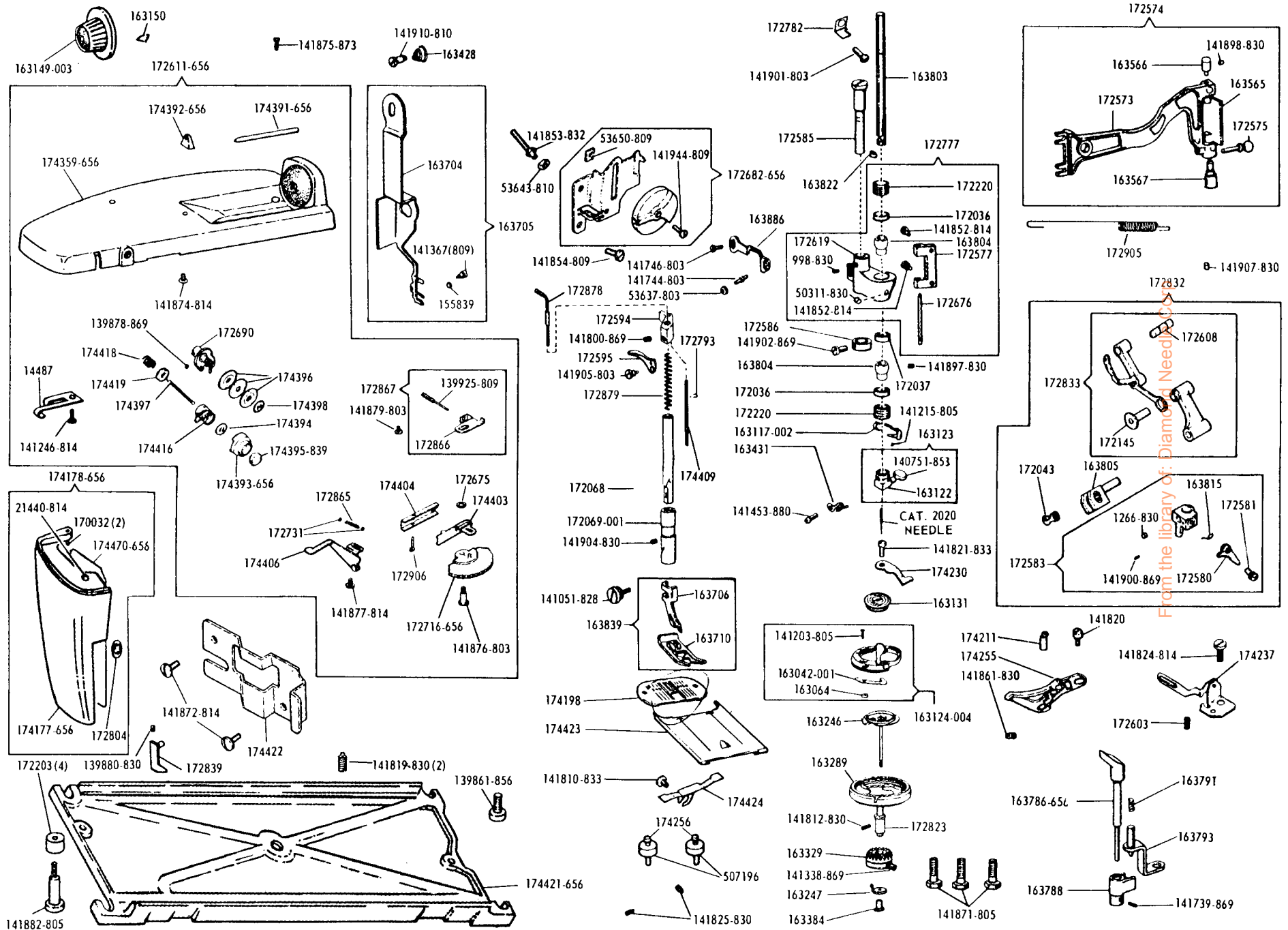

From the library of: Diamond Needle Co.

List of Parts—Machines Nos. 756E3, 756E6 and 756E7

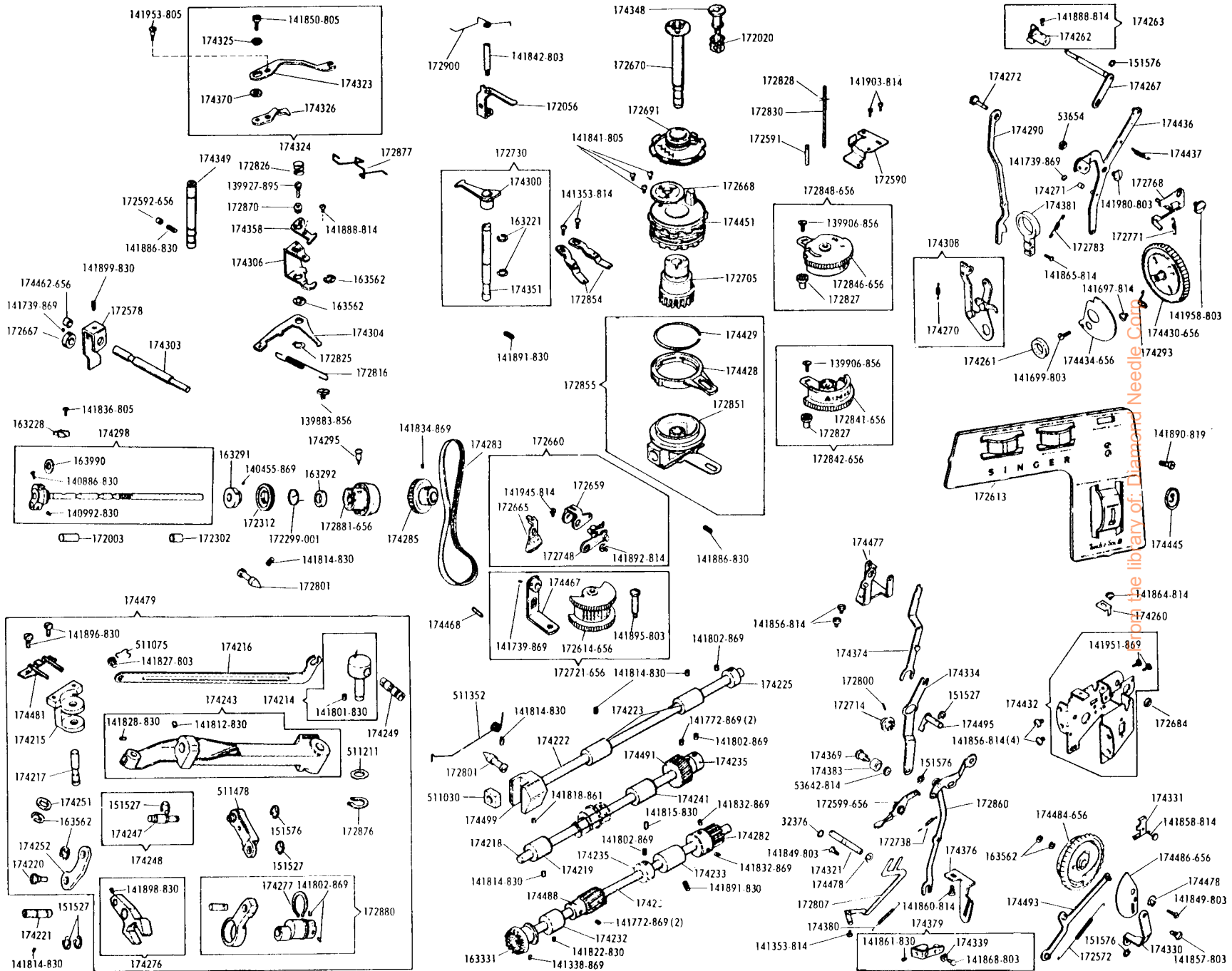

Electrical Parts—Machines Nos. 756E3, 756E6 and 756E7

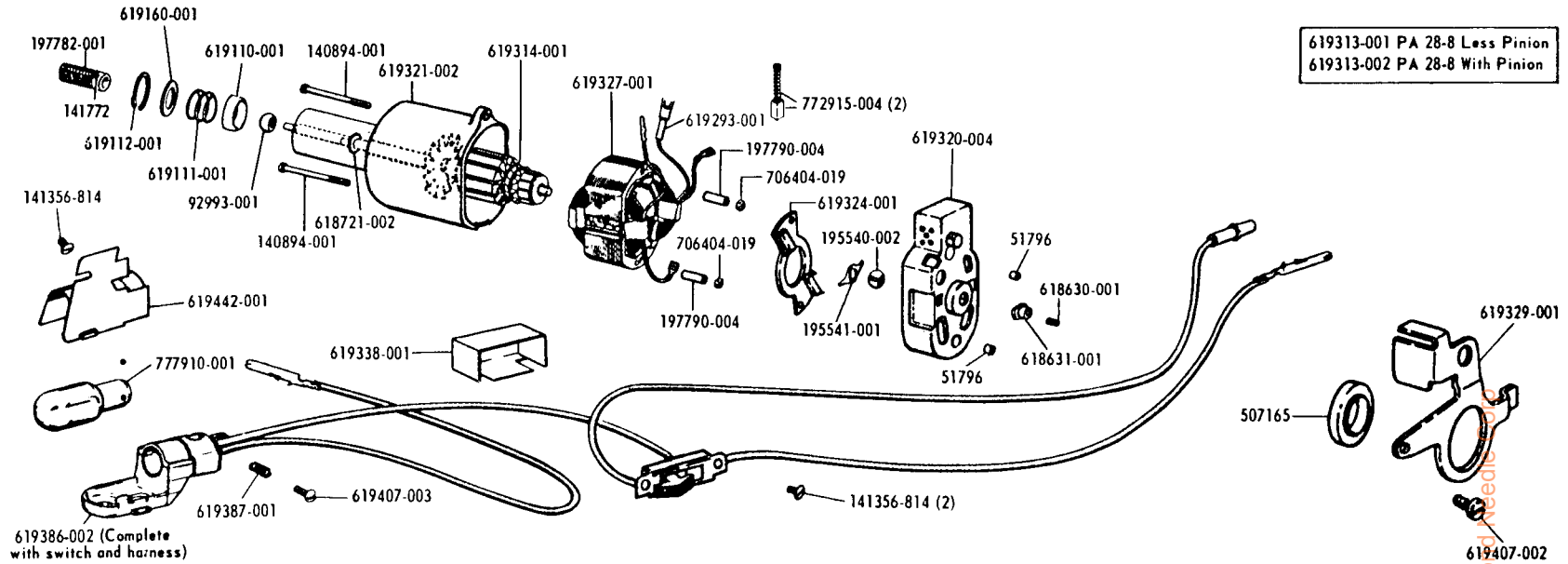

619313-001 PA 28-8 Less Pinion
619313-002 PA 28-8 With Pinion

From the library of: Diamond Records

